

06 - 08 / DECEMBER 2011  
 Expo Transamerica  
 D/E Pavilion  
 São Paulo - Brazil

# Exhibition Hall

FLOOR PLAN - Esc. 1/400  
 Updated - 2011 October 04  
 Subject to changes

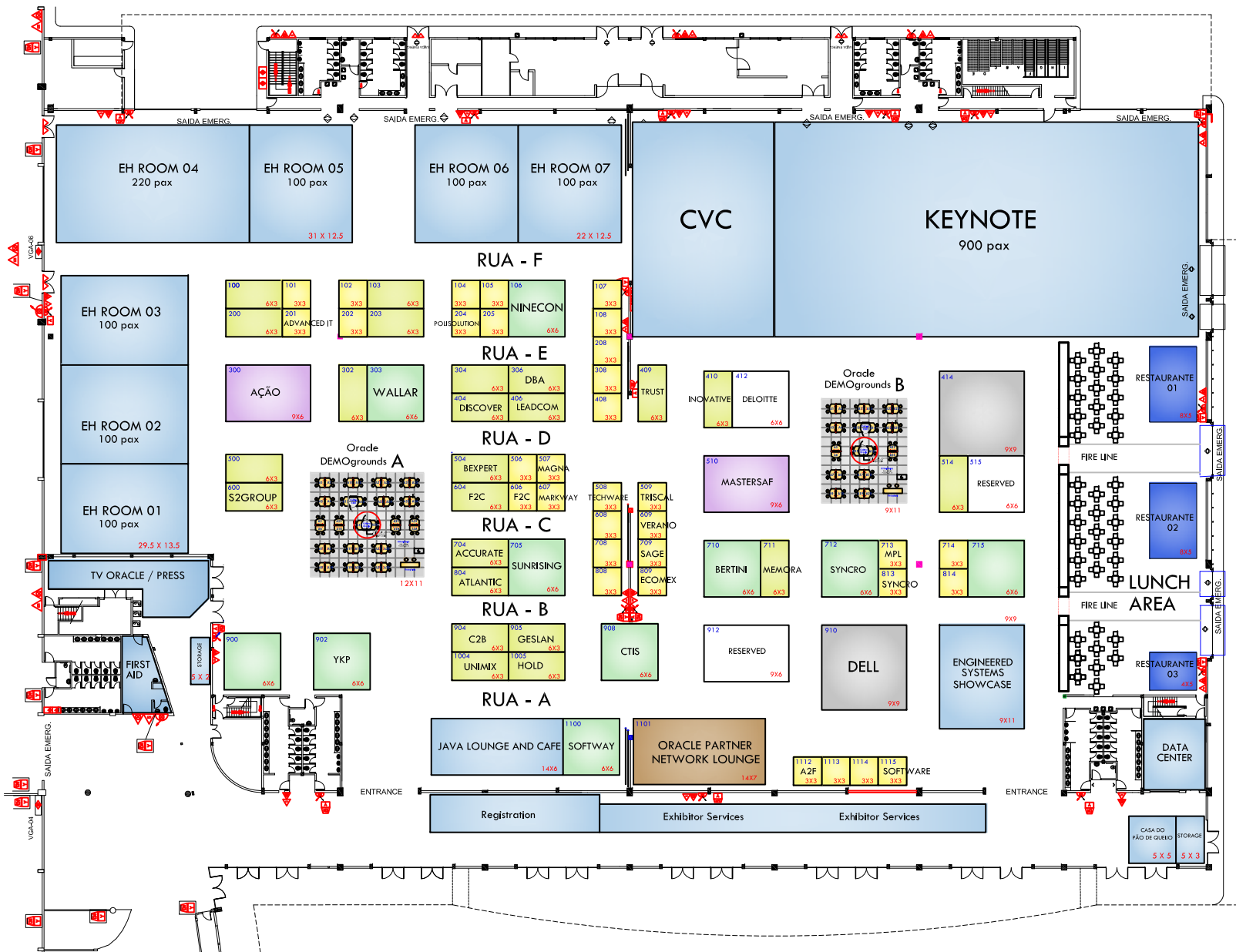

## LEGEND:

- 33 UNITS  3X3 - 09m<sup>2</sup>
- 23 UNITS  3X6 - 18m<sup>2</sup>
- 12 UNITS  6X6 - 36m<sup>2</sup>
- 03 UNITS  9X6 - 54m<sup>2</sup>
- 02 UNITS  9X9 - 81m<sup>2</sup>
- RESERVED AREAS